

## Check all componets

\*Please check each component is included in the package before you go through.

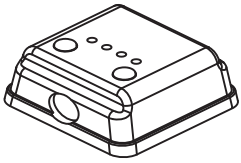

Control Box - 1 PC

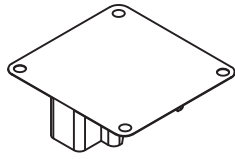

Clamp.Top - 1 PC

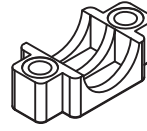

Clamp.Bot - 1 PC

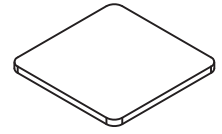

3M Tape - 1 PC

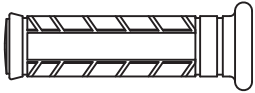

Heat Grip - 1 PAIR

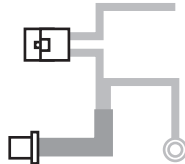

ConnectorWire - 1 SET

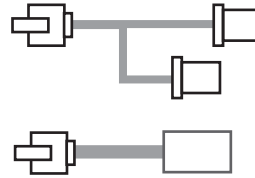

Thumb Heater - 1 SET

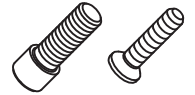

Hex.Screw - 2 PCS  
SelfTap.Screw - 4 PCS

## Wiring Connect Guide

\* Damage can occur due to the wrong installation or incorrect wiring.  
If you are unsure please ask your local dealer for assistance.

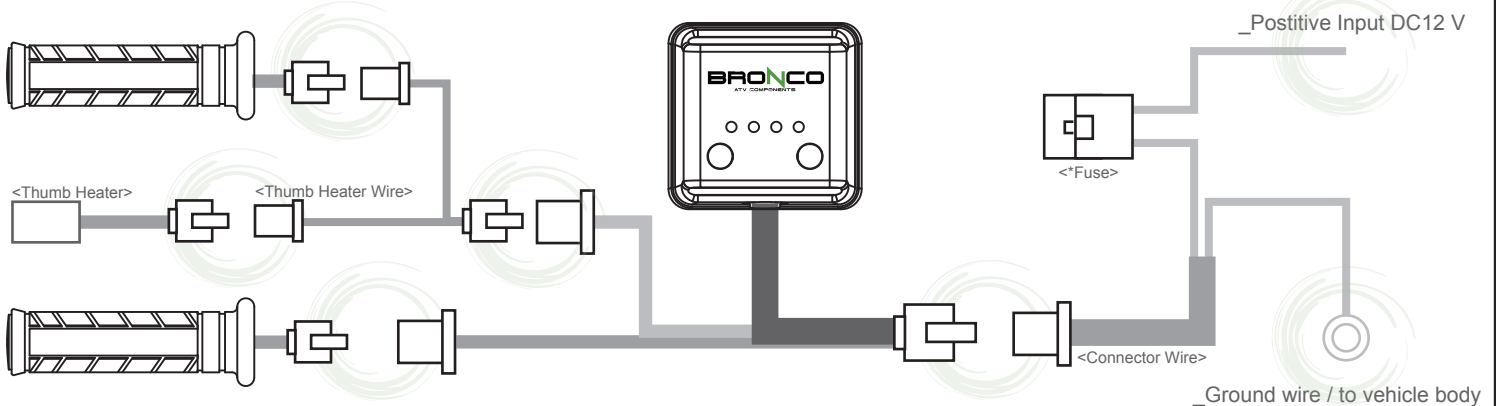

\* To avoid insufficient voltage regulation or potential damage and to avoid Battery drain it is beneficial to wire the grips to shut off when power supply to vehicle is turned off.

## Control Box Assembling

\* Damage can occur due to the wrong or inappropriate assembling of the Control Unit.  
If you are unsure please ask your local dealer for assistance.

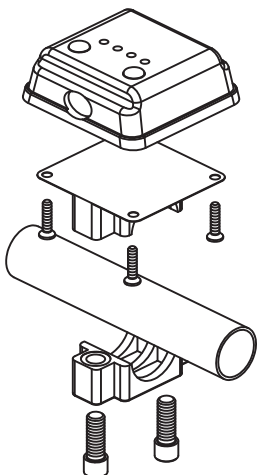

Screw on Handle-Bar

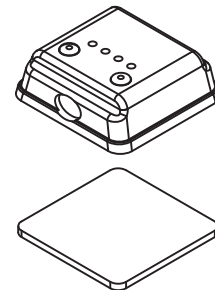

Attach to body / surface

< OR >

Turn back for operation instruction.

## Startup the Heated Function



### Switch On

Press the ON-Button for 2 seconds and then release, the blue light will flash.

### Increase Heated Level

After the blue light flash, repeat the same action on pressing On-Button. The green light will flash and the temperature will increase.

## Adjust the Temperature



### Increase Temperature Level

Simply press the ON-Button and then release, the indicator light will flash to the next level.

### Decrease Temperature Level

Simply Press the OFF-Button and then release, the indicator light will flash back to the previous level.

## Switch Off the Function



### Switch Off the heated function

Simply press the OFF-Button and hold for 2 secs, the first level (blue flash) will be off. The heated function will be successfully switched off.

## Temperature Graph

### Level Indicator

- 1
- 2
- 3
- 4



\*Measured under 25°C  
\*Tolerance +/- 5°C

