



**Honda  
Grom®**

photo by Alexandre Blais



**Honda  
Monkey®**



**KOSO**   
NORTH AMERICA

# Koso's philosophy

---

Koso, a synonym for quality and performance. With more than 35 years of experience designing and manufacturing high quality products, Koso has become well known across the powersports and OEM industries for its good reputation for reliability, innovation and capability. Whether we are manufacturing a product under private label, OEM or aftermarket products quality always remains our top priority. Innovation and creating new technologies are the keys to Koso's philosophy and drives us to continue pushing the limit further.

For several years now, Koso has had the opportunity to work with an outstanding team of engineers. Along with our state of the art testing equipment and production facilities, Koso has remained a leader in analog and digital technology. Koso produces a wide range of quality gauges/meters, heated equipment, LED indicators taillights and headlights as well as mirrors and engine parts. Koso is proud to offer a complete line of quality products for serious riders.

---

**KOSO**   
NORTH AMERICA

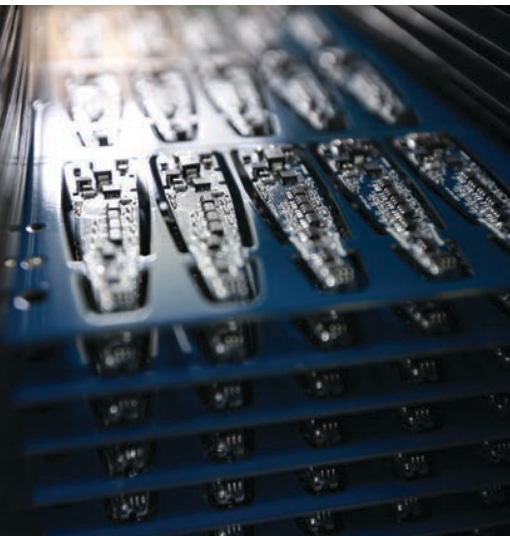

## LCD gear display

Always wondering in which gear you're in? Avoid this question by using our plug & play gear indicator. Lightweight, compact, easy to use and to install, this meter will quickly tell you which gear you've selected. Its big digits and blue backlight make it easy to read during day or night riding. Made to fit the Honda Grom® models, this meter is a great addition for serious riders.



# Gear indicator

part

**KN002001**

## Specifications

- Gear indicator  
R: N, 1, 2, 3, 4, 5, 6
- Effective temperature range  
14 ~ 140 °F (-10 ~ 60 °C)
- Effective voltage  
DC 12 V
- \*fits Grom® and Monkey®

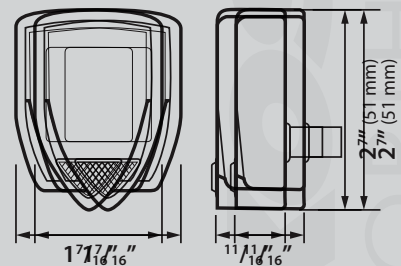

# DB-03R

part

**BA038900**

## Multifunction meter

The DB-03R is a multifunction meter with a modern casing that provides necessary critical readings. The DB-03r features all standard indicators needed to operate a vehicle on the street as well as 3 adjustable RPM/TACH scales to choose from in the settings. The DB-03R also features a three color changeable backlight. Other functions include: Speedometer, odometer, trip, temperature, voltage and fuel level.

■ \*fits Grom® only

  
**PLUG N PLAY**



## Specifications (R = Range U= Unit)

- **Speedometer**  
R: 0 ~ 225 MPH (0 ~ 360 km/h)  
U: MPH or km/h
- **Odometer**  
R: 0 ~ 99,999 miles (km) | U: 1 mile (km)
- **Tripmeter A/B**  
R: 0 ~ 999.9 miles (km) | U: 0.1 mile (km)
- **Total hour meter**  
R: 0 ~ 99,999 H | U: 1 H
- **Hour meter A/B**  
R: 0 ~ 999.9 H | Unit: 0.1 H
- **Tire circumference**  
R: 300 ~ 2,500 mm | U: 1 mm  
Sensitive point: 1 ~ 20
- **Tachometer R:**  
10,000 RPM (1 level = 166 RPM)  
12,000 RPM (1 level = 200 RPM)  
15,000 RPM (1 level = 250 RPM)
- **RPM warning / shift-light**  
R: 1,000 ~ 15,000 RPM | U: 100 RPM
- **Warning**  
Light on (F-OFF) | Flash (F-ON)
- **Maximum RPM record**  
R: 0 ~ 10,000 / 12,000 / 15,000 RPM
- **RPM input signal number setting**  
R: 0.5, 1 ~ 24
- **RPM input pulse**  
R: HI-ACT (positive wave pulse)  
LO-ACT (negative wave pulse)
- **Volt meter**  
R: DC 8 ~ 18 V  
Flashing warning when voltage is lower than DC 11.5 V or higher than DC 15.5 V
- **Thermometer**  
R: 32 ~ 482 °F (0 ~ 250 °C)  
U: 0.1 °F or °C (alternative)
- **Over temperature warning**  
R: 140 ~ 482°F (60 ~ 250°C) | U: 1°F (°C)
- **Top temperature record**  
R: 0 ~ 482°F (250°C)
- **Fuel meter**  
R: 6 levels | U: 1 level = 16.6 %
- **Fuel resistance**  
R: 100 Ω / 250 Ω / 510 Ω / 1,200 Ω / SW
- **Clock R:** 24 H format
- **Backlight brightness**  
R: 1/5 (darkest) ~ 5/5 (brightest)
- **Backlight colors**  
Blue / Orange / Purple
- **Indicator lights**  
Neutral / High beam / Turn signals/  
Check engine Oil level / Temperature /  
Speeding / RPM shift light
- **Gear indicator**  
R: N, 1, 2, 3, 4, 5, 6, 7, 8, 9
- **Effective temperature range**  
14 ~ 140 °F (-10 ~ 60 °C)
- **Effective voltage** DC 12 V
- **Sensor included**  
Passive speed sensor: BF019J06  
Temperature sensor: BF030000

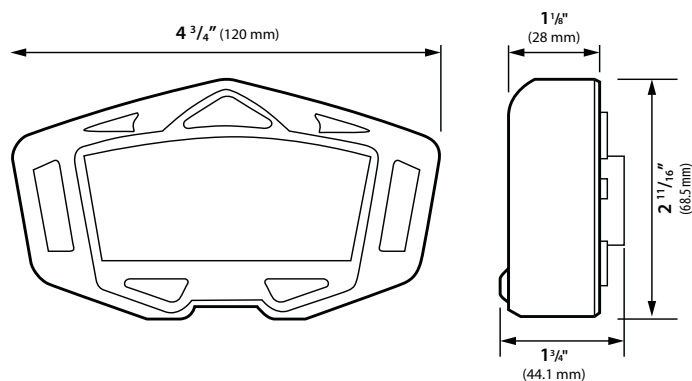

# Mini 3

part  
**BA003245**  
cylinder head temperature  
meter

**BA003214**  
ambient air temp.

**BE030000**  
top clamp red.

**BE030100**  
top clamp silver.

**BA030200**  
top clamp black.

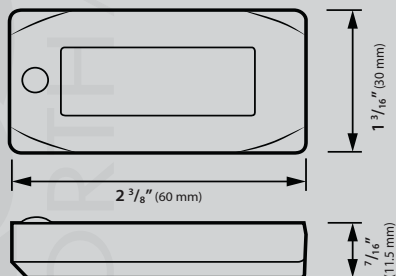

## Mini 3 air/fuel ratio & temperature meters

The Mini 3 series has been developed with the best components and latest technology. Compact, lightweight and easy to connect, the Mini 3 meters are a must have.



### Specifications (R = Range U= Unit)

- Effective temperature range  
14 ~ 140 °F (-10 ~ 60 °C)
- Power DC 12V

## Air/fuel ratio meter

Our Mini 3 air/fuel ratio meter was especially designed to help you tune your engine. This meter can be easily installed by plugin it to your OEM oxygen sensor and connecting the instrument to a DC 12 V source of power, and you're ready to go!

### Specifications

- Air/fuel ratio meter  
R: 12.2 ~ 17.2 | U: 0.1
- Display  
L: if A/F > 17.2 | A: if A/F < 12.2
- \*fits Grom® only



## Cylinder head temp.

This compact and lightweight Mini 3 engine temperature meter is especially designed for Honda Grom®. This meter is the perfect addition to monitor your ride, it's peak recall function allows you to see the maximum temperature reached..

### Specifications

- Temperature & Max temp record  
R: t-1: -4 ~ 392 °F (-20 ~ 200 °C)  
t-2: -40 ~ 365 °F (-40 ~ 185 °C)  
t-3: -4 ~ 428 °F (-20 ~ 220 °C)  
t-4: -4 ~ 392 °F (-20 ~ 200 °C)  
t-5: -4 ~ 248 °F (-20 ~ 120 °C)  
U: 0.1 °F or °C (alternative)
- \*fits Grom® only



## Top clamp

This useful top clamp will help you get a clean look even with an additional meter. Whether you choose one of our plug-in meter for Honda Grom® or one of the Mini 3 series, this Top clamp is the perfect compliment.

- \*fits Grom® only



# Hurricane Air Filter

part

**A DK623000**

Honda Grom®

**B DK633000**

Honda Monkey®

new

## Specifications

### ■ Connecting tube

Our air box connecting tube has been developed to link the Koso's 34 mm throttle body and the actual air box.

### ■ Rubber intake

The main function of this intake is to meet the demand of a larger cylinder and therefore improve air intake volume for a better efficiency, \*\*fits Grom® only.

## Hurricane racing air filter

Want better performance with a simple change? Using the Hurricane multi air filter intake will increase the airflow, improve filtering efficiency and raise the engine output performance. These high-quality foam filter is easy to assemble and disassemble and suitable for long-term use with repetitive cleaning



**DM623000**  
Connecting tube



**DM623000**  
Rubber intake\*\*





# Starter

new

## High power starter

You've added some performance to your Honda Grom® / Honda Monkey® engine and now you want a clean start every single time? This newly designed High power starter is the solution for the high compression setup you now have. No more hesitation, get a fresh start.



part

**FR623000**

### Specifications

- Robust casing
- Brushed aluminum finish
- High power output to optimized starting process
- fits Grom® and Monkey®



KOSO  
NORTH AMERICA

# Ignition Coil

new

part

**KU623100**

## Specifications

- High power ignition coil
- Built using high quality materials
- Direct fit For Honda® Grom & Honda® Monkey

## Ignition Coil

Koso's high performance ignition coils are designed using the most advanced materials on the market today. Providing a stronger spark and more horsepower, the koso ignition coil also provides smoother idling and acceleration.



## NGK spark plug

This spark plug is the best one to fit your newly modified Honda Grom® or Honda Monkey® with the Koso 170cc big bore kit. It is designed to give you a more powerful spark and enhance your bike performance.



# Spark plug

part

**NGK-ER9EH**

# Throttle body

part

**DY623013**

■ fits Grom® and Monkey®

## 34mm Throttle body

The throttle body and intake manifold are used to control the amount of air flowing to the engine's combustion chamber, they are important elements of the admission system. Using our Koso's 34 mm throttle body in conjunction with our 30.5 to 34mm intake manifold will allow a better air/fuel mixtures for a quicker throttle response.

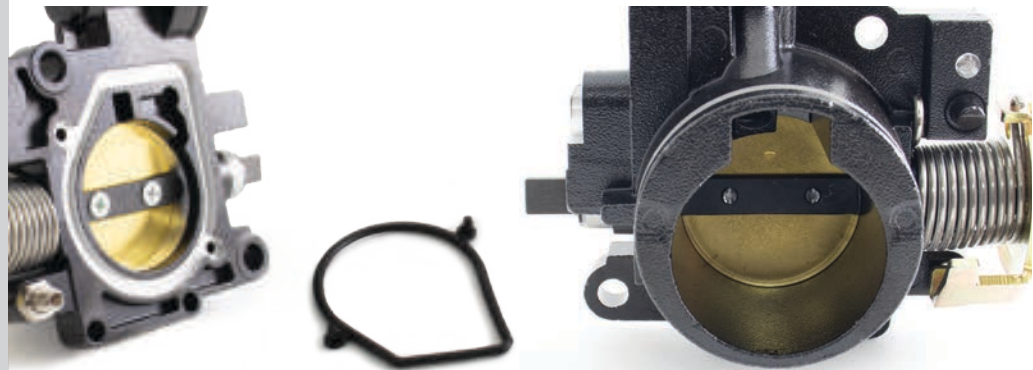

## Performance intake manifold

The throttle body and intake manifold are used to control the amount of air flowing to the engine's combustion chamber, they are important elements of the admission system. Using our Koso's 34 mm throttle body in conjunction with our 30.5 to 34mm intake manifold will allow a better air/fuel mixtures for a quicker throttle response.



# Intake manifold

part  
**DP623001**  
intake manifold

**DP623K000E**  
replacement paper gaskets

■ fits Grom® and Monkey®

KOSO  
NORTH AMERICA

# Injector

part  
**DB008160**  
high flow injector

**DB623000**  
injector adaptor

■ fits Grom® and Monkey®

## High flow injector & injector adaptor

Your need for speed pushed you to install our 170cc Big Bore kit and 4 valves head? Unleash the full power of that transformation by using our high-flow injector. A small upgrade for better performance!



# Camshaft

## Performance camshaft

Our 240 degrees performance camshaft will give you great results at high RPM. This camshaft can be used with a stock engine, but will even give better results with the Koso 170cc big bore kit. Made from quality material for longer durability, the Koso GROM camshaft is a clever choice.



part  
**MM623002**

### Specifications

- Duration at 1mm  
In: 260 Ex: 265
- Valve lift  
In: 8.5mm Ex: 8.5mm
- Running clearance  
In: 0.10mm Ex: 0.17mm
- fits Grom® and Monkey®



# Oil pump

part

**NF623000**

■ fits Grom® and Monkey®

## High-flow oil pump

Our Koso's High-flow oil pump for Honda Grom® is strongly recommended for those who upgraded their engine with our 170cc Big Bore kit and 4v Cylinder head. The addition of this high quality part will increase the oil flow by 40%; which is a very effective modification that will help prevent engine failure. Keeping the engine lubricated and cool is very important; whether you ride for fun or for races.





## Hi-performance clutch kit

When it comes time to transferring the power of your engine to the ground, the clutch components are one of the important keys. Using our hi-tension clutch springs along with the hi-performance clutch discs will help improve the axial force and reducing the risk of clutch slipping.



# Clutch kit

part

**FA623002**

full kit

- fits Grom® and Monkey®
- includes 6 hi-tension clutch springs
- includes hi-performance clutch discs & clutch plates

# Clutch lifter plate

part

**FA623K00**

■ fits Grom® and Monkey®

## Clutch enhanced lifter plate

The main difference between our Koso clutch enhanced lifter plate and the stock one is strength. Our CNC lifter plate is stronger to provide better durability and stability to the clutch during replacement, installation and shifting gears during high speed movement.

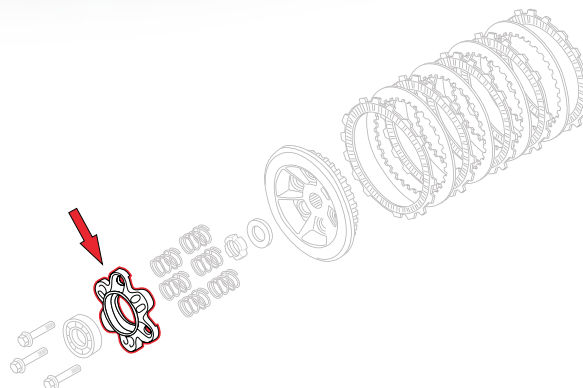

## Hi-tension clutch springs

Your clutch springs may be the weak spot in the powertrain. These springs are 60% stiffer than the stock ones and are intended as a direct replacement. The springs will offer stronger grip of the clutch system when shifting gears. They are sold as a six pieces kit.

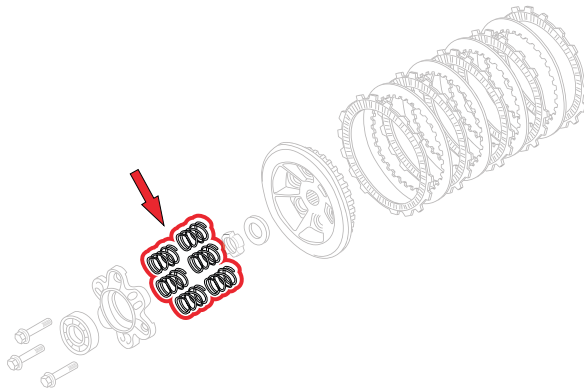

# Clutch springs

part

**FT623001**

- fits Grom® and Monkey®
- replacement parts for the Koso Clutch kit\*

# Clutch discs

part

**FA623000**

clutch discs

- fit Grom® and Monkey®
- replacement parts for the Koso Clutch kit\*\*

## Hi-performance clutch discs

Designed to transfer the power of your engine to the ground, the clutch components are one of the important keys. These hi-performance clutch discs are a direct replacement for the Koso clutch kit.

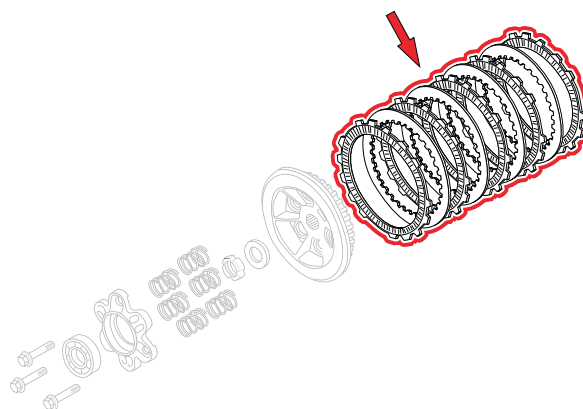

## Cam chain tensioner

Made from resistant high quality material, our Koso chain tensioner could save your engine from expensive damage. We came up with this long lasting solution to replace the OEM chain tensioner which has a tendency to wear prematurely.



# Chain tensioner

part

## MU623000

- The arm is made with Aluminum 6061, and the wheel is made with JIS SCM415 (=SAE 4115) Alloy Structure Steel (Chromium Molybdenum Steel).
- Works on stock engine and highly recommended to use with our Big Bore & 4V Head kit.
- fits Grom® (2014 & up) and Monkey®

KOSO  
NORTH AMERICA

# Big bore kit

part

## MB623002

Honda® Grom /  
Honda® Monkey

### Specifications

- Cylinder displacement: 169.2cc
- Cylinder material:  
Aluminum / ceramic coated
- Piston size: 61mm
- Piston type: Forged
- Compression ratio: 11.5 : 1
- Kit includes piston, rings, pin,  
pin clips, gasket kit, banjo bolts  
and cylinder

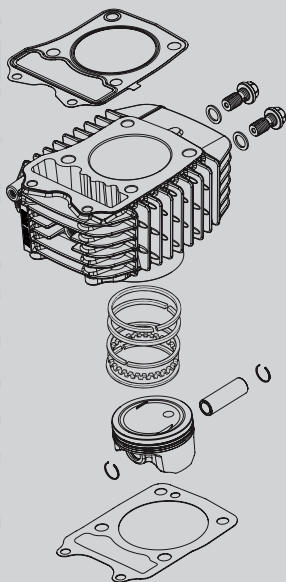

## 170cc big bore kit

Want to unleash all the power your Honda Grom® can handle? Our 170cc Big Bore kit is the perfect addition for you ! The kit includes a ceramic coated cylinder, 61 mm forged piston, rings, pin, gasket kit and banjo bolts. Its compression ratio of 11.5 to 1 will allow you to still use premium pump gas and keep the reliability of a stock motor. Made from the best components available on the market, our 170cc big bore kit will amaze you !



# 4V Head

## 4V head kit

Our Koso 4V Head Kit is the ideal engine part to complete the Koso Honda Grom® Big Bore kit. Because of its unique 4 valve design, the air flow and performance are increased. This new designed head is the perfect addition for those who desire more power and torque. The 4 Valve Head Kit features a forged piston, stainless steel 24 mm intake valves and 20 mm exhaust valves. **Only fits Koso 170cc big bore kit**



part

## MC623000

Honda® Grom /  
Honda® Monkey

### Specifications

- Cylinder height: 64.2 mm
- Gasket thickness:  
Upper: 0.25 mm | Bottom: 0.5 mm
- Piston compression height: 19.5 mm
- Volume: 169.21cc
- Squish: 1mm
- Cylinder head titration: 13.4 cc
- Compression ratio: 12.3 : 1
- Valve / Tappet clearance:  
IN: 0.10 mm EX: 0.17 mm
- Camshaft: Torque: 1.71 Hp: 26.26  
*\*measured without air filter &  
no noise reduction plug*
- **\*\*Requires the use of Iridium  
spark plug: NGK-ER9EHIX  
(part NGK-ER9EH) or  
Denso # IY27, IY29 or IY31**

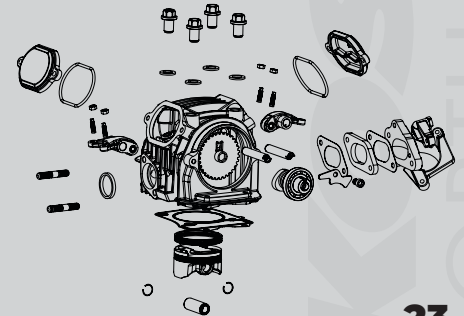

# Complete kit

part

## MB623003

Complete kit

Replacement part

### A XT623MM101

4V camshaft

### B MD623010

4V forged piston

### C XT623MT101

Exhaust rocker arm

### D XT623MT001

Intake rocker arm

### E MQ623E20SE

Exhaust valve

### F MQ623E005E

Intake valve

### G DP623K300E

Manifold gasket (oval)

### H DP623K500E

Thermal insulation gasket

### I MC623K000E

Exhaust gasket

## 170cc big bore kit & 4V head kit

This complete top-kit is the perfect add-on for all horsepower enthusiast looking for performance ! It includes : a 170cc ceramic coated cylinder, forged piston, performance camshaft, bearing, rocker arms, 4 valve cylinder head, intake manifold, gaskets, and more. All parts are made from High-quality components for reliability and durability that allow you to put your mind at ease and ride with confidence !

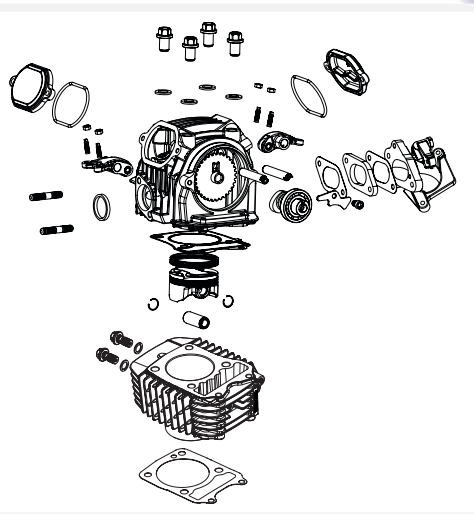





# Thunderbolt

part

**GA002000**

## Specifications

- Class D brightness level
- Brightness :
  - Low beam : 1058 lumens
  - High beam : 813 lumens
- Built in CNC made housing allowing easy installation
- \* E-mark and DOT compliant

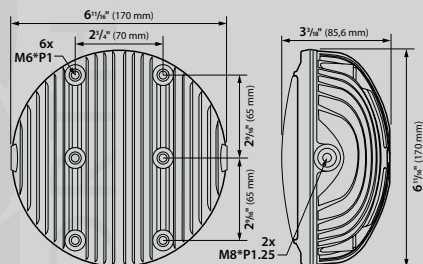

## LED headlight

A brighter headlight means more security, this is the reason why Koso decided to release its new Thunderbolt LED headlight. This headlight features a light weight but durable aluminium housing and is one of the only headlights on the market today to be produced using CNC technology. This headlight is universal meaning it can fit virtually any bike and is also DOT certified.

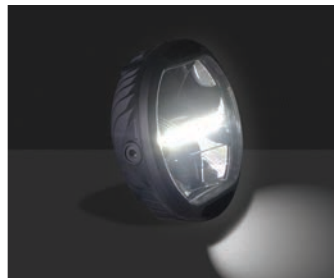

## Dual LED headlights

The new Hawkeye dual headlight give an awesome custom look while providing powerful LED brightness. These headlights feature light weight and durable CNC aluminium housing that can be installed on virtually any application. E-Mark and DOT certified.



part

### GA004100

dual headlight full kit

#### Specifications

- Separate low and high beam
- Class D brightness level
- Brightness :
  - Low beam : 1058 lumens
  - High beam : 813 lumens
- Built in CNC made housing allowing easy installation
- \* E-mark and DOT compliant

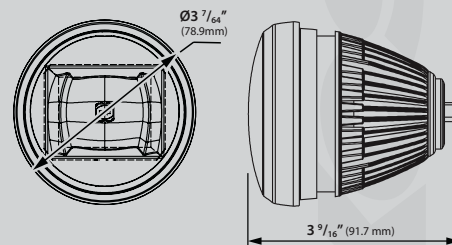

# Aurora

part

**HG008001**

## Specifications

### LED fog lights

- Brightness: 420 lumens each
- Angle of pitch  
+90° / +45° / 0 / -45° / -90°
- Temp range:  
14 ~ 140 °F (-10 ~ 60 °C)
- Effective voltage: DC 10 ~ 16 V
- Temp range:  
14 ~ 140 °F (-10 ~ 60 °C)

### Controller

- Power: DC 12 V / 7 W

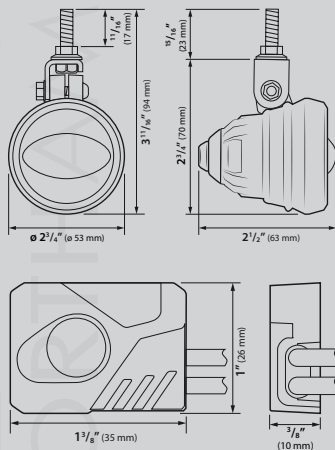

## LED fog lights

When it comes to riding motorcycle, security should definitely be a priority. This is why the use of fog lights is a must for seeing and being seen under bad weather conditions. Lightweight, easy to install and adjustable, our Koso quality Aurora fog lights will complement your ride.

\* DOT & ECE compliant.

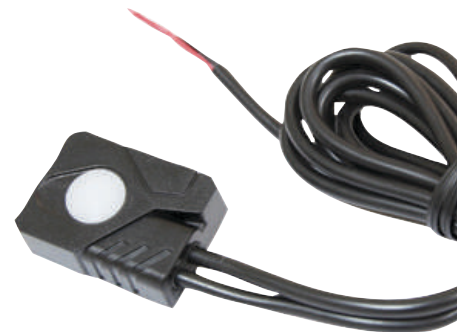

# Infinity

## LED taillight

Set your motorcycle apart using the Koso Infinity taillight. Available with red or smoke lens, its 6 ultra-bright LED lights will increase your visibility. This taillight also has a license plate light which makes it better. Affordable and easy to install, this is a must to customize your motorcycle or scooter.



part

**HB025020**

red lens

**HB025010**

smoke lens

### Specifications

- 6 ultra-bright LED lights
- License plate light
- Red or smoke lens

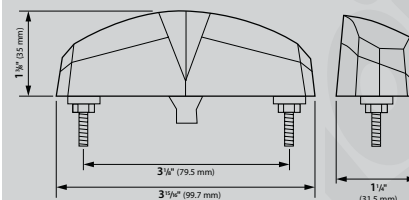

# Nano

part

**HB026000**

red lens

**HB026010**

smoke lens

## Specifications

- 1 ultra-bright LED light
- Red or smoke lens

## LED taillight

Our Nano brake light is probably one of the smallest, brightest and lightest taillight on the market. Its ultra-bright LED is made to increase the rear visibility and allow you to ride safely. Its compact shape makes it perfect for all naked bikes and for those who like minimal accessories. Affordable and simple to install, this Nano taillight will certainly enhance the look of your ride !

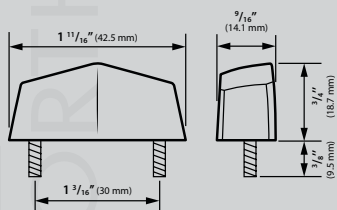

## LED taillight

The Koso Solar LED taillight is a great way to modernize the look of your bike. Keeping with the classic circular shell, this taillight is powered by ultra-bright LED's that enable you to be more visible on the road. DOT and SAE approved, this taillight is sure to enhance the look of your bike all while keeping you safer at the same time.



# Solar

part

**HB035020**

red lens

**HB035010**

smoke lens

### Specifications

- Red or smoke lens
- DOT & SAE approved

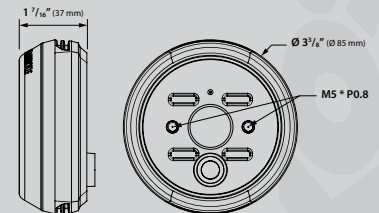

# GT-01

part

**HB031000**

red lens

**HB031100**

smoke lens

## Specifications

- Red or smoke lens
- Halo style daytime running light
- 3 ultra-bright LED lights brake lights

## LED taillight

The latest LED technology in the form of a taillight. Whether you are looking to bring your bikes lighting up to date or looking to set your ride apart you can rest assure Koso's Halo taillight will provide. Featuring the latest and greatest Ultra bright LED technology you can rest assure other motorists will spot you on the road all while providing a great modernized look.

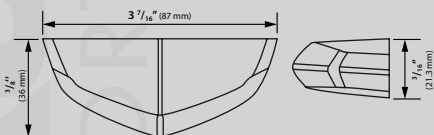



# Hawkeye

## LED taillight

The Hawkeye taillight is a micro high power LED that also features a license plate light. This taillight may be small however the ultra-bright LED makes it extremely visible during day or night. Universal fitment designed to fit any application.



part

**HB034000**

red lens

**HB034010**

smoke lens

### Specifications

- Dual function
- 1 ultra-bright LED light
- License plate light
- Red or smoke lens

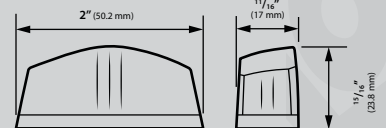

# Blade

part

**HD008000**

## Specifications

- Range: DC 10 ~ 18 V
- Max voltage: DC 24 V < 60 sec
- DOT compliant

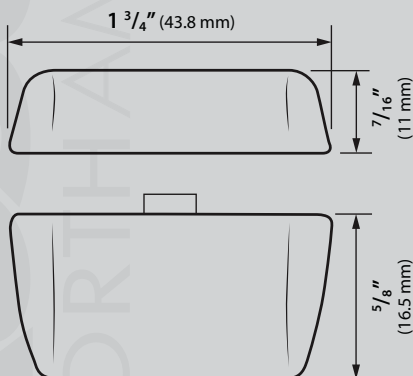

## LED license plate light

Our constant desire to add new products to our accessory line has pushed us to develop a small, compact and easy to install license plate light. Its specifications, quality components and Ultra-bright LED light are the reasons behind its DOT compliance. This item is a must to customize your motorcycle at a low cost.

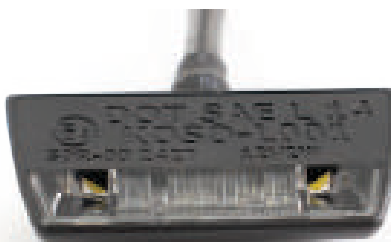

## LED license plate light

this new LED license plate light will give you the compact and easy to install license plate light features and bring a stylish twist to your typical license plate light. Its specifications, quality components, and Ultra-bright LED light are the reasons behind its DOT compliance. This item is a must to customize your motorcycle at a low cost.



part

**HD009000**

### Specifications

- Range: DC 10 ~ 18 V
- Max voltage: DC 24 V < 60 sec
- DOT compliant

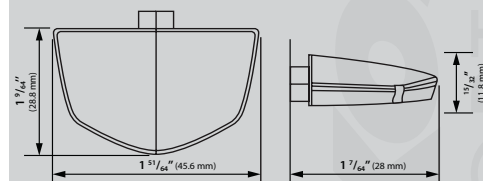

# GW-02

new

part

## HE044000

Smoke

### Specifications

- Dynamic (sequential) indicator
- 5 high power ultra-bright LED lights
- Aluminium shell
- Smoke lens
- Soft stem design
- M8 threading
- Sold as pair

## LED indicator lights

The Koso new GW-02 sequential LED indicator gives any bike a style statement. The sequential indicator powered by five high powered LED's provides modern style as well as blinding brightness to keep you safe on the road regardless of whether its day or night.

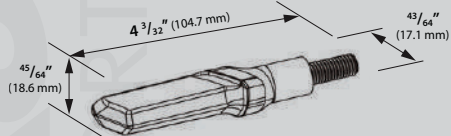

# Stinger

## LED indicator lights

Looking to customize your motorcycle at a low cost? Our Stinger LED indicators will definitely do the job ! They are available in matte black with a choice of smoke or clear lens, and they feature a Hi-power amber LED to increase visibility. Their modern style will be the perfect complementary item to enhance the look of your ride !



part  
**HE100010**  
smoke lens

**HE100000**  
clear lens

### Specifications

- 1 hi-power ultra-bright LED light
- Amber LED
- Clear or smoke Lens
- Soft stem design
- M8 thread
- Sold per set of 2

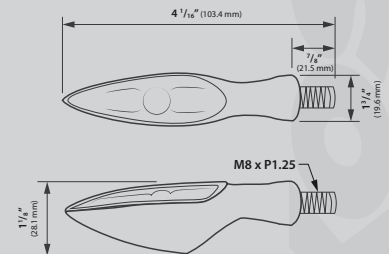

# Nuovo

new

part  
**HE032010**  
smoke lens

**HE032020**  
amber lens

## Specifications

- 6 ultra-bright LED lights
- Amber LED's
- Amber or smoke Lens
- Soft stem design
- M8 thread
- Sold per set of 2
- DOT, SAE & E-mark approved

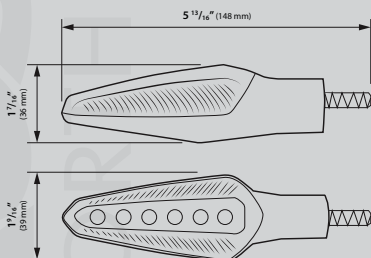

## LED indicator lights

The Koso Nuovo LED indicator lights are a great way to modernize the look of your bike without straying away from the OEM appearance. Sold in a pair of two, DOT and SAE certified. These indicators feature 6 ultra-bright LED's per indicator to keep you safer and more visible when changing lanes.



# Nano

new

## Nano LED series

Big things come in small packages. The Koso Nano LED series does not disappoint. These pea sized LED indicators are available as turn signals, brake light or a dual function brake light + turn signal combo. Small on size but big on brightness, the Nano(series, collection) features high power LED's that are sure to be seen by all vehicles on the road day or night.



part

**HE041001**

indicator (pair)

**HE041101**

dual (pair)

**HE041200**

brake light (single)

### Specifications

- Thread size M6
- Amber turn signal
- Micro size for a clean install
- High power LED

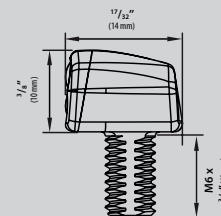

# Unlimited

part  
**HE015K14**  
matte black

**HE015S12**  
silver

**HE015M12**  
chrome

## Specifications

- 5 ultra-bright LED lights
- Amber LED
- Clear lens
- Soft stem design
- M8 thread
- Sold per set of 2

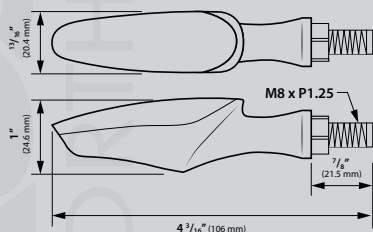

## LED indicator lights

Koso Unlimited LED indicator lights use 5 ultra-bright amber LED lights to increase visibility. Sold in pair and available in matte black, silver or chrome, they are perfect to customize your motorcycle at low cost. A simple change, for a better look !





# Infinity

## Dual LED indicator lights

Koso Infinity LED indicator lights are available in 2 models. The DUAL function is a brake light & indicator light. It is used for the rear end; the other is a SINGLE indicator light function for the front end. They are built with 2 ultra-bright LED, one is RED as the brake light and the other is AMBER as the indicator light. Having a hi-power LED brake light into the indicator light will increase the visibility of the motorcycle and make it easier to see for other drivers. The Infinity dual hi-power LED are not only a matter of look... but also a matter of safety.



part  
**HE030011**  
smoke lens / single function

**HB030011**  
smoke lens / dual function

**HE030001**  
clear lens / single function

**HB030001**  
clear lens / dual function

### Specifications

- 2 hi-power ultra-bright LED lights
- Amber and red LED
- Clear or smoke Lens
- Dual and single function
- Soft stem design
- M8 thread
- Sold per set of 2

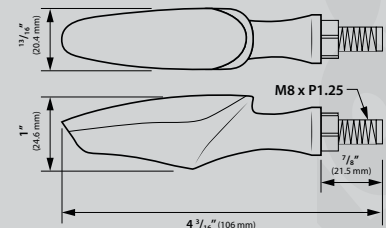

# Jet

part

## HE101K30

matte black / smoke lens

## HE101K20

matte black / clear lens

## HE101S10

silver clear lens

### Specifications

- 1 hi-power ultra-bright LED light
- Amber LED
- Clear or smoke lens
- Soft stem design
- M8 thread
- Sold per set of 2

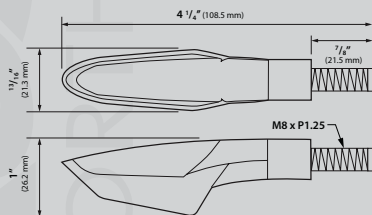

## LED indicator lights

Koso Jet LED indicator lights use the new High-power LED technology. In fact, it is so bright that it uses only 1 light for an ultra-bright luminosity. Sold in pair and available in matte black or silver, they are perfect to change the look of motorcycle without any hassle. A simple change for a better look !



# Mars

## LED indicator lights

Koso Mars LED indicator lights use the new High-power LED technology. In fact, it is so bright that it uses only 1 light for an ultra-bright luminosity. Sold in pair and available in matte black or silver, they are perfect to change the look of motorcycle without any hassle. A simple change for a better look !



part  
**HE103K11**  
matte black / smoke lens

**HE103K01**  
matte black / clear lens

**HE103S01**  
silver clear lens

### Specifications

- 1 hi-power ultra-bright LED light
- Amber LED
- Clear or smoke lens
- Soft stem design
- M8 thread
- Sold per set of 2

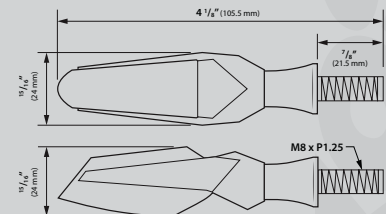

# Z3

new

part

## HE039200

Amber

### Specifications

- 4 high power ultra-bright LED lights
- Plastic shell
- Soft stem design
- M8 threading
- Sold as pair

## LED indicator lights

The Z3 ultra bright LED indicators by koso are a great set of affordable indicators. Bring your bike to the next level by upgrading your indicators. These Indicators not only happen to look good but they also provide more safety while out on the road with the blinding brightness of high power LED's.



## LED indicator lights

The koso Electro sequential LED indicator is a great addition to any bike regardless of the make or style. The sequential indicator powered by five high powered LED's provides modern style as well as blinding brightness to keep you safe on the road regardless of whether its day or night.



part

**HE037021**

Amber

**HE037011**

Smoke

### Specifications

- 5 high power ultra-bright LED lights
- Aluminium shell
- Available in clear or amber lens
- Soft stem design
- M8 threading
- Sold as pair

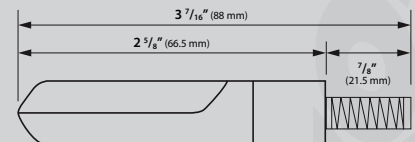

# Indicator misc

part

**KD006030**

LED flasher relay

**BO623K02**

indicator light adaptor kit

## LED flasher relay

Once you replace your regular bulbs by LED indicators, the resistance is very small compare to the original flashers. Therefore, the bike couldn't identify whether the flashers are installed or not so they will not flash normally. Avoid this problem by using our simple flasher relay. Install only one Koso relay for all 4 LED indicator lights.



## Indicator light adaptor kit

This kit allow you to conveniently install any of our LED indicator lights to your Grom. Sold as a pair, they fit front or back (2 pairs required if you change all 4 flashers)



# Sprint

new

## Mirrors

Large display replacement mirrors that add style to your ride. Our New Sprint Style mirrors will give a unique look to your motorcycle! These mirrors fit M8 and M10 size with black matte stem and shell.



part

**SA000003**

Black shell / Clear lens

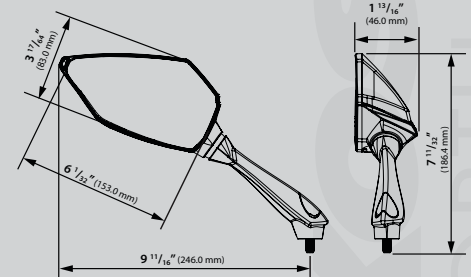

# TT-Style

part

- A OA016CS0**  
Carbon look shell / Clear lens
- B OA016KS0**  
Matte black shell / Clear lens
- C OA016CK2**  
Carbon look shell / Clear lens
- D OA016CS6**  
Carbon look shell / Blue lens
- E OA016CK6**  
Carbon look shell / Blue lens

## Mirrors

Our TT Style universal mirrors will change the style of your bike for good. Available in M10 size with carbon look or matte black shell.

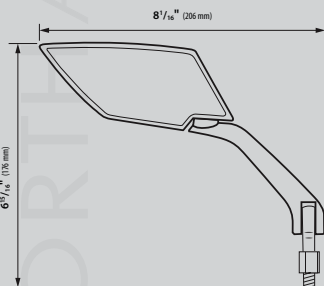



### Specifications

A

- Carbon look shell
- Clear lens
- Silver stem



### Specifications

D

- Carbon look shell
- Blue lens
- Silver stem



### Specifications

B

- Matte black shell
- Clear lens
- Silver stem



### Specifications

E

- Carbon look shell
- Blue lens
- Black stem



### Specifications

C

- Carbon look shell
- Clear lens
- Black stem



# Devils Style

part

**OA018CK1**

Carbon look shell / Clear lens

## Mirrors

Get a modern look to your bike with our Devils Style universal mirrors. Available in M10 size with carbon look shell.

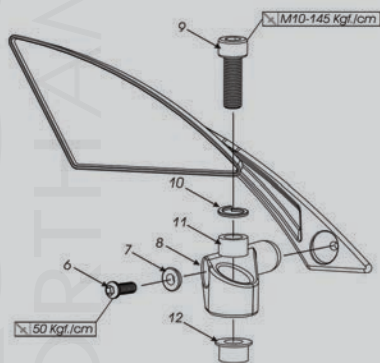

# Blade Style

## Mirrors

Looking for affordable and durable mirrors? Our Blade Style mirrors will customize your motorcycle and give it a special look at low cost ! Available in M10 with carbon fiber look shell and black matte shell.



part

**OA015C10**

Carbon look shell / Clear lens

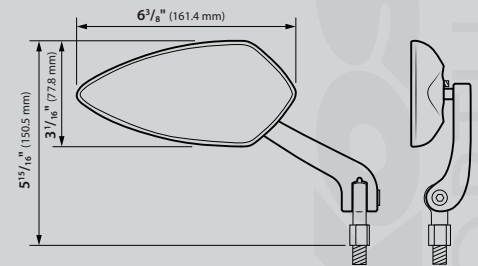

# GT Style

part

**OA013K10**

Black shell / Clear lens

## Mirrors

Want something different? Our GT Style mirrors will give a unique look to your motorcycle! Available in M10 size with black matte stem and shell.

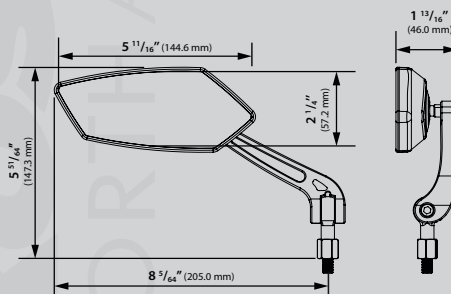

52



# Apex

new

## Mirrors

The new Apex mirrors combine look and functionality. You want something different? These mirrors will give a unique look to your motorcycle! Available in M10 size with black matte or carbon look shell.



part

**SB000010**

Matte black shell / Clear lens

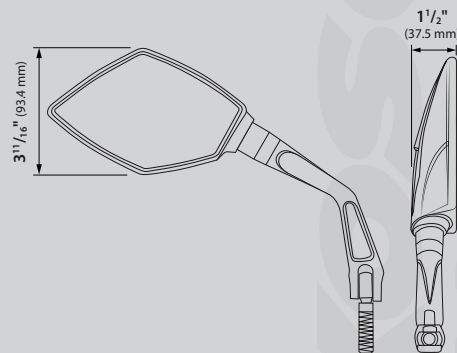

# Apollo

part

**AM111010**

120 mm

## Specifications

- Integrated temperature level thumb switch
- Universal fitment (120mm or 130mm)
- 5 temperature levels to choose from indicated by multi-color LED
- Low battery cut off protection
- Internal memory that allows grips to power on at previous heat level
- Fits L:7/8" – R:1" handlebar for twist throttle applications

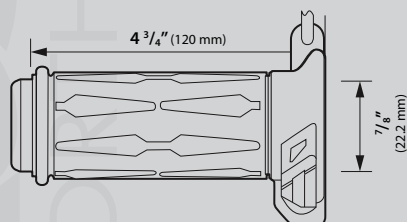

## Heated grips universal fit

The Apollo heated grips are a prime example of koso's ability to innovate. Finished are the days of cluttering your handlebars with control boxes and switches. The Apollo heated grips feature koso's exclusive integrated thumb switch which provides you with the ability to power on and off the grips as well as rotate between the 5 levels of temperature.



# X-Claws

new

## Heated Clip-On with Lo Hi switch (for 12V power source)

These new heated devices are for the user that does not want to commit to changing their grips but still want to maintain the comfort of heated grips. The fitment is intended to fit all sorts of handlebar sizes. They can be installed and removed in a matter of seconds and kept in any sport bag when not in use. The power source requires a 12V connection. There is 5 levels of heat offered to suit your preference.



part

## AX1200M0

Universal fit

### Specifications

- 12V power source requires 10W minimum
- Lo and hi level inline switch
- Universal fit to be clipped on any handlebar sizes
- Rubber material that is resistant to outdoor conditions and high temperatures
- Thin and flexible silicone wires make them easy to install

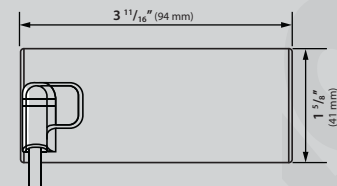
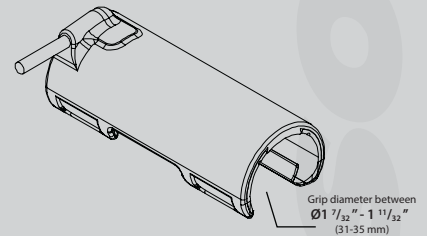



**KOSO**   
NORTH AMERICA



Learn more about motorcycle parts we have.